

# Stanmer Woods

















# Woodland Management Plan

Following a public consultation from December 2017 to February 2018 a Woodland Management Plan has been approved for Stanmer Park and Estate.

This was confirmed by the Forestry Commission, the government department responsible for protecting, expanding and promoting the sustainable management of woodlands and increasing their value to society and the environment.

The WMP aims to:

- bring Stanmer's woodland back into active management
- maintain a balanced woodland ecosystem
- ensure that nature conservation, the landscape and historic environment are protected and enhanced

Activities resulting from the WMP will include:

- widening rides and key paths to diversify and create corridors for wildlife and add to park users' experience
- coppicing small areas to diversify the woodland structure
- thinning woodland to select for native and healthy trees
- ensuring adequate regeneration through natural means or re-planting

[Download the Woodland management plan](#)

# Woodland Management Plan

<b>Woodland Property Name</b>	<b>Stanmer Park</b>	
<b>Case Reference</b>	40206	
<b>Plan Period dd/mm/yyyy (ten years)</b>	<b>Approval Date:</b> 02/08/2018	<b>To: 2028</b>
<b>Five Year Review Date</b>	2023	

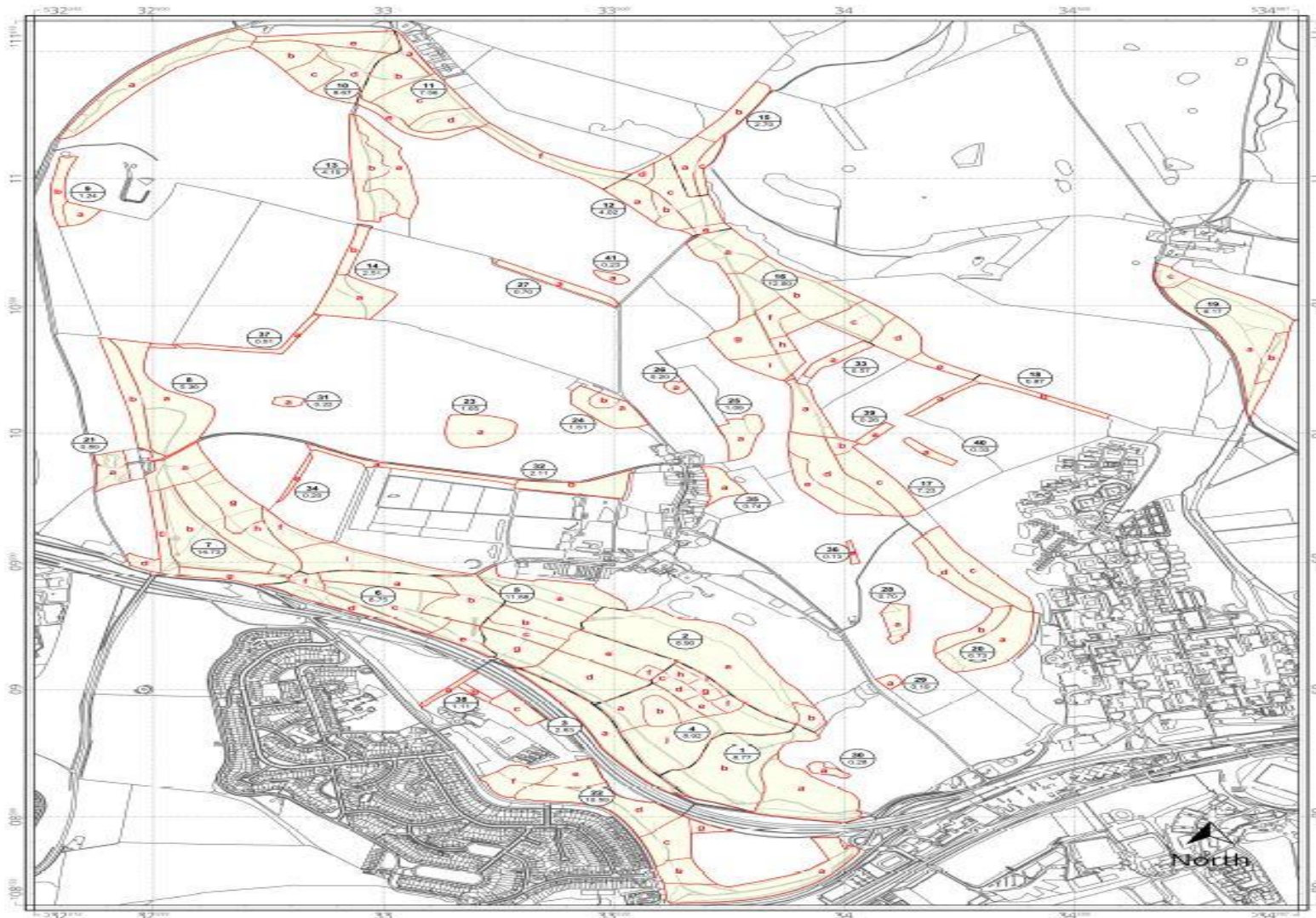

**Stanmer Park Map 2 - sub-compartments**  
 Scale: 1:10,000 (on A3 paper)  
 Print Date: 20/02/2015  
 Grid ref at centre: TQ336099

-  Subcompartment boundary
-  Compartment boundary



**Brighton & Hove**  
 City Council

© Crown copyright. All rights reserved. Licence 100020999, Brighton & Hove City Council 2016

















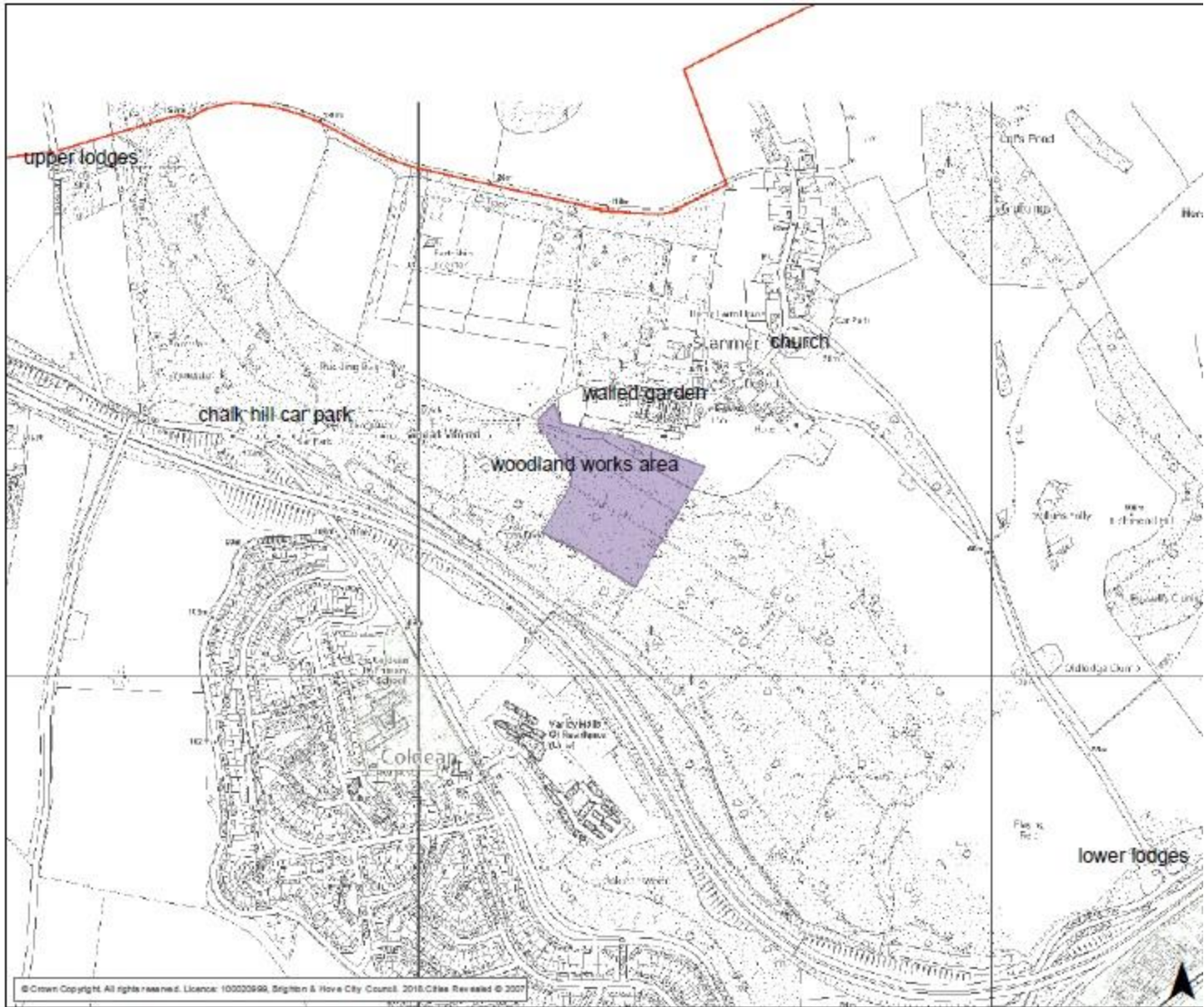











# **STANMER ANCIENT WOODLAND MANAGEMENT REVIEW**

## **PART 1**

Dolphin Ecological Surveys 2020

on behalf of

Brighton & Hove City Council





# SUSSEX BAT GROUP



Registered Charity No: 1103380

[About Us](#)[Bats in Sussex](#)[Bat Care and Rescue](#)[Events](#)[Membership](#)[The Belfry Newsletter](#)[Bat Records](#)[Licence Training](#)[Contacts](#)

## About Us

The Sussex Bat Group was formed in 1984 to help conserve bats in East and West Sussex. The Group is a registered charity made up of volunteers who share a passion for bats. We are affiliated with the Bat Conservation Trust.

Bats are facing serious population declines across the UK. There is a bat group in nearly every county working to help reverse this decline.

### The aims of the Sussex Bat Group are to:

- Help conserve bats and their habitat.
- Raise awareness of bats and their conservation.

### These aims are achieved by:

- Recording and monitoring bat populations in Sussex.
- Assisting Natural England with roost visits where threats to bats may exist.
- Carrying out conservation projects such as bat box schemes, improving roost sites or opening and protecting potential sites.
- Organising talks and educational events throughout the year.
- Providing a [care and rescue service](#) for sick and injured bats, with the back up of permanent bat hospitals.





We use cookies to improve our service. By using this site, you agree to this use. [See our cookie policy](#)

Accept and close ✓



NEW [Give feedback](#)

Services

Search

**Coronavirus (Covid-19):** Latest information and advice about coronavirus in Brighton & Hove.

[Find out more](#)

You are here: [Home](#) > Woodland management plan

# Woodland management plan

Download the Woodland management plan.

## Featured PDF



**Woodland management plan**

863.6KB PDF

[Find out more](#)

[Contact](#)